



INSTALLATION GUIDE

VERSION 1.0 | RCC08192023 | 02/2024



Before installing, please ensure you have downloaded the latest version of this installation guide by scanning this code.

STEP 1

Fasten the joist to Wall A using an appropriate fastening system. A suitable joist could include treated timber, steel, aluminium, WPC, or a PVC material. It is essential that all external corners are at 90 degrees. You may need to shim sections to ensure the angle is correct.

A joist span of 400 mm is recommended.

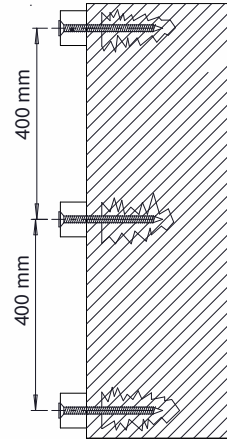
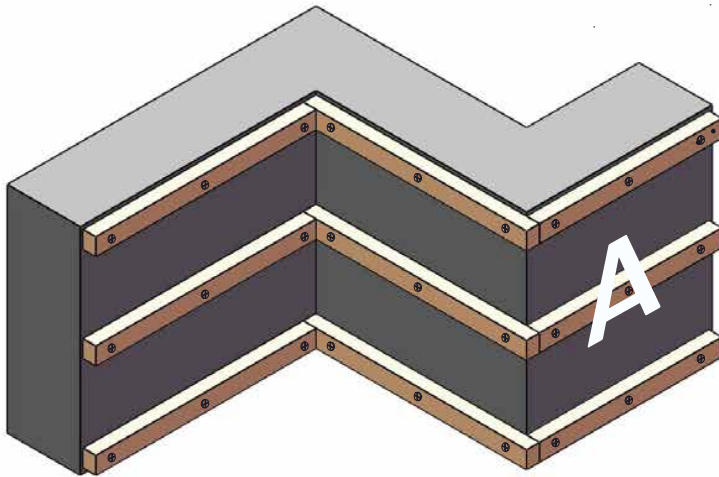

STEP 2

Start by installing the external corner cladding trim board first. Using an appropriate top fixing screw at every joist

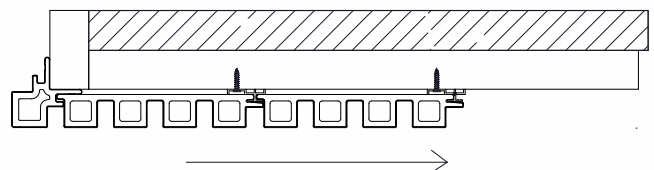
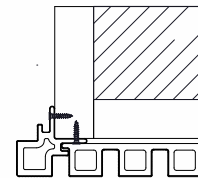
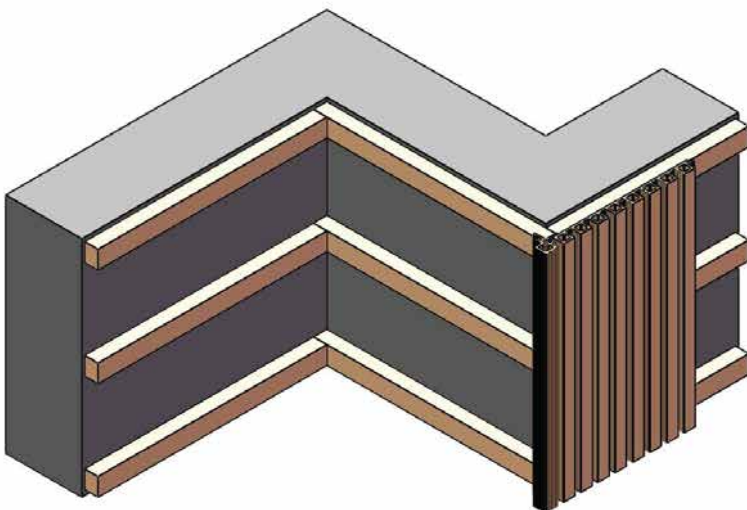

STEP 3

Measure the remaining portion of the wall, taking into account the width requirement of the trim profile if being used. Wherever the remaining gap doesn't allow the use of a full width board, use a circular saw or table saw to rip the next castellated cladding board to size. Wherever possible, try and rip the last profile down the middle of two flutes. Depending on your chosen finishing option, you might at this point need to top fix your last board at every joist interaction.

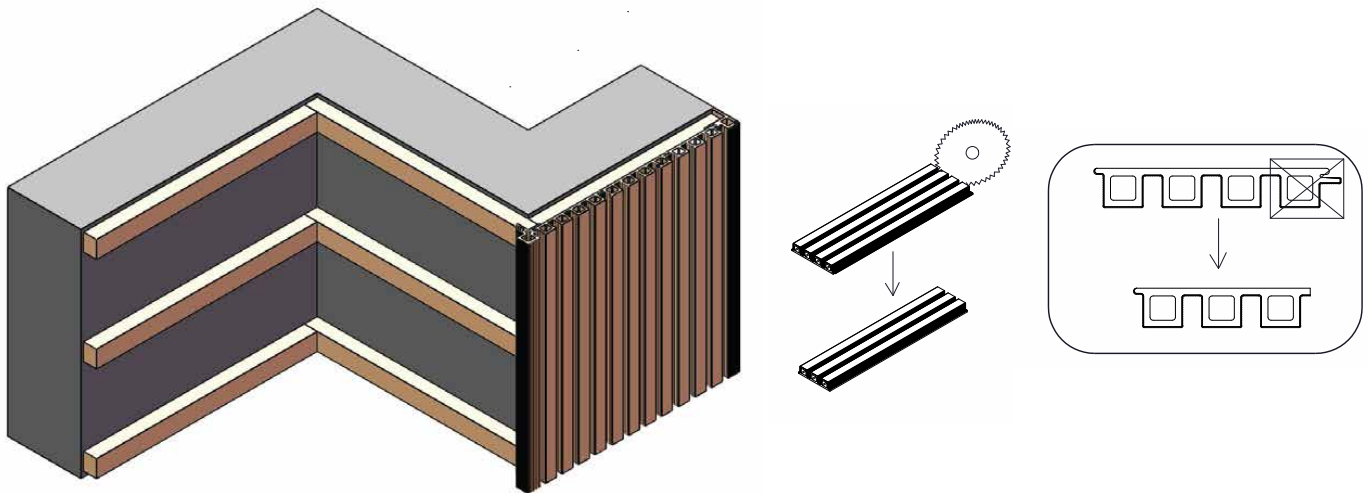

STEP 4

At this step you can add a finishing profile to your installation. If a cover angle is being utilised, pre-drill an oversized hole through the cladding profile first. Be sure to top fix the aluminium trim angle to the underlying structure and not to the cladding boards. Do not overtighten the top fixing screws.

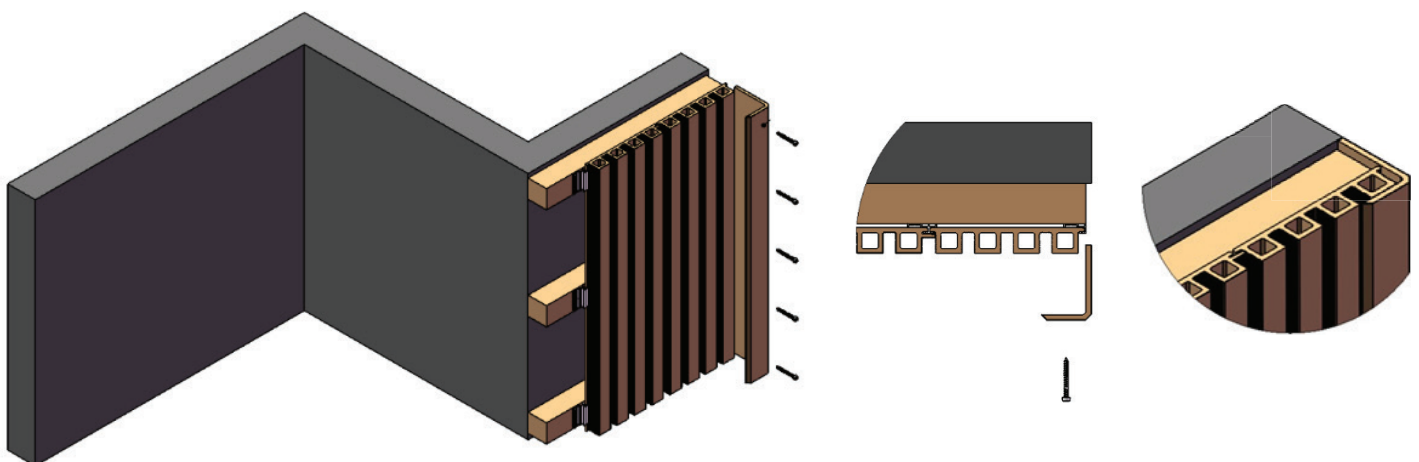

STEP 5

External corner installation

Ensure that the correct angle is achieved before completing the adjoining wall. Install the first cladding board of Wall B by repeating the process described in STEP 2.

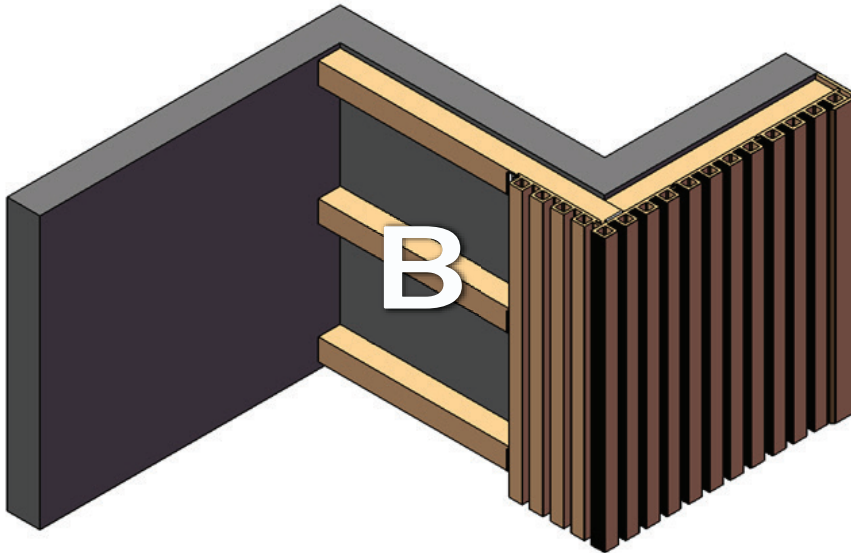

STEP 6

Continue installing the castellated cladding system, ensuring that you check, at regular intervals, to ensure boards are properly aligned and neatly connected at the corners and on the edges.

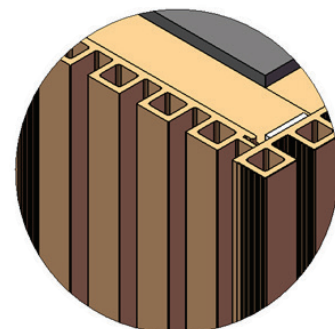
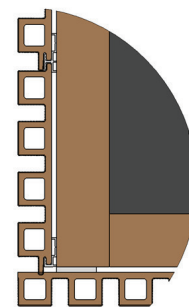
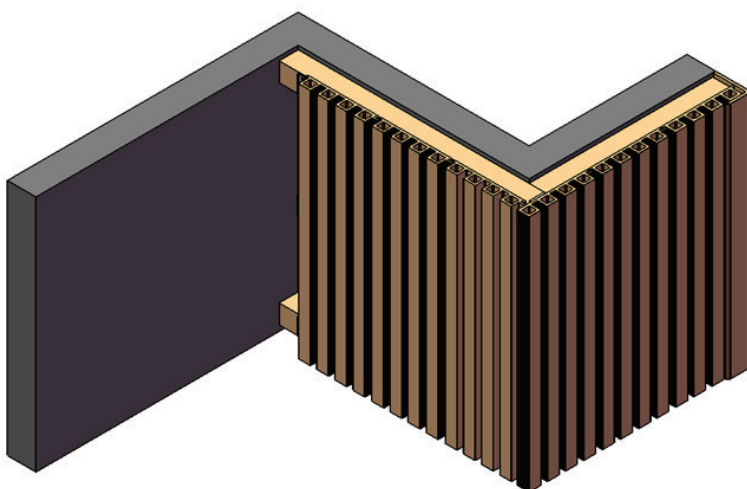

STEP 7

Internal corner installation

It is advised that wall C's structure also join to wall B on a 90-degree angle wherever possible. Install the last cladding board of Wall B using the revive aluminium clip and install the first cladding board of Wall C by repeating the process described in STEP 2.

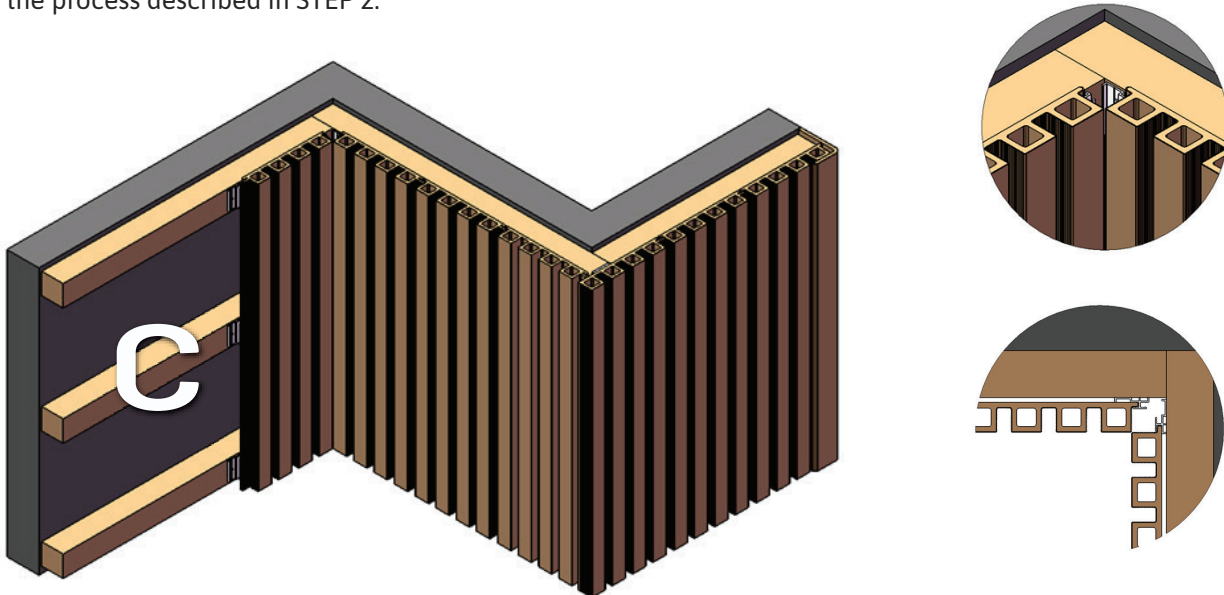

STEP 8

To finish off your facade, repeating the process described in STEP 4.

