



Skirtex® installation instructions

1. Measuring and joining

- Measure the length of skirting you need and cut it to size either with a sharp utility knife or hacksaw and mitre box to get a perfect vertical edge.
- If you require longer lengths, you can join Skirtex® lengths together with a 45 degree mitre cut on each end. Apply contact adhesive to both ends, wait the desired time until the glue is tacky, and then join.
- Tip : Heat both ends of the Skirtex® with the glue on with a heat gun. Join and press the ends together for an almost instant bond.

2. Applying Contact Adhesive

- Make sure both surfaces are clean and free of dust.
- Take a pencil and mark the height of the Skirtex® on the wall.
- Apply contact adhesive evenly to the back of the Skirtex® and onto the wall until just below the marked pencil line.
- Allow both surfaces to get tacky (follow instructions on adhesive product) and then press the Skirtex® onto the wall firmly.
- Other construction adhesives may also be used. Please follow the manufacturer's instructions. Some are acrylic types, so they may be easier and less messy to work with but without the initial bonding strength of contact adhesive.

3. Going around sharp corners

- Although Skirtex® is flexible, it is usually 10 or more millimetres thick, and to go around a sharp 90 degree corner, you have 2 options.
 - a. You can cut and mitre it like a standard skirting board and join the two ends together at 90 degrees, or
 - b. You can make small relief cuts on the inside of the Skirtex® with a utility knife or hacksaw blade, about 5mm deep, and then bend it around the sharp corner.

4. Fitting and sealing Skirtex® products

- Start on one end slowly and firmly pressing the Skirtex® onto the wall.
- Because Skirtex® is flexible, it will highlight irregularities if you are using it on a straight wall. Be sure to keep the Skirtex® running straight even if the wall has slight undulations. You can fill gaps later.
- If you are going around pillars, be sure to measure and cut accurately so that the two ends meet perfectly at the other end of the pillar. You can also use a 45 degree mitre cut on both ends in such cases to make the joining easier.
- Gaps can be sealed with a caulking gun and an acrylic sealer/filler after the adhesive has dried/cured.
- Smooth with a damp cloth/finger or tool.

5. Painting

- Skirtex® requires painting, and it has been primed for painting at the factory.
- Ensure the adhesive and any filling is completely set and dried.
- You can use any oil or acrylic or water based pva paints.
- You can also stain Skirtex® if you wish. You may also spray paint Skirtex® prior to installation, but remember that any extreme bends will require some touching up after installation.
- Similar to wood, Skirtex® may require a light sanding after the first coat.
- Apply the second coat for a smooth even finish.

6. Finished product

The finished painted Skirtex® provides a flexible, durable, and seamless look on curved or straight walls.

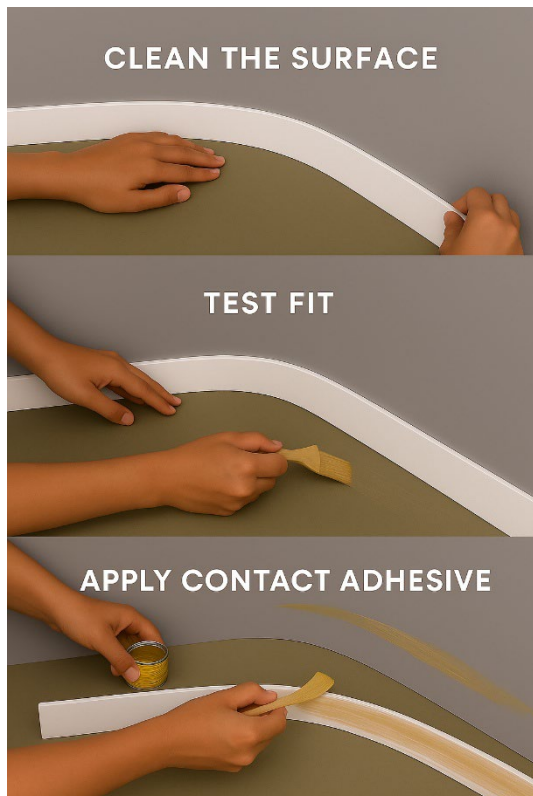

*** Skirtex® is a registered trademark of Mr Cornice (PTY) Ltd